

- Compact solution with shutting off.
- Saves time during installation and montage.
- Minimal number of potential leakage points.
- Clear and simple to maneuver, reducing the risk of incorrect operation.



Air manifolds type VL are aimed for the general supply of compressed air. Inlets are available in both ends and the connections are G1/2. The outlets are located on one side and in G1/4. Each outlet has a space saving built-in valve of on-off type. The type number will give the available number of outlets.

## Type number

VL-	3	5	6	8	10	12	15	16
-----	---	---	---	---	----	----	----	----

## Options

**NPT-threads. Add suffix -N to type number.**

## Technical information

Body/block	Anodized aluminium
Valves	Stainless steel EN 1.4305 SS2346
O-rings	Nitril
Inlets	2 x G1/2 Alt. NPT
Outlets	G1/4 alt NPT
Max. pressure	10 bar
Max. temp	60 gr C
Fluid	Air and non corrosive gas

Juni 2014

Note. For your safety - block not used slots. Use a 1/4" plug.

Options:  
NPT-threads.

Dimensions

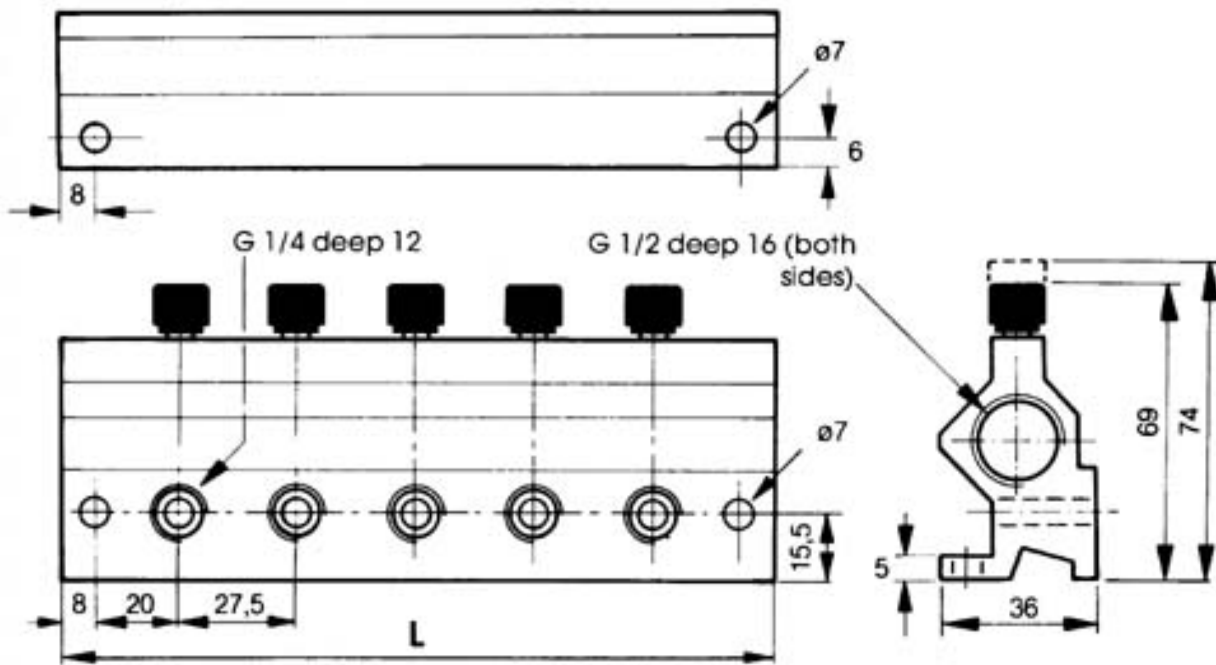

VL-	3	5	6	8	10	12	15	16
L (mm)	111	166	194	249	303	358	441	469

Juni 2014